



FORK HAND TRUCK

WITH **DUAL WHEELS**
INSTRUCTION MANUAL



67294-75

CONTENTS

Specs	3
Parts Diagram	4
Assembly	5

TOOLS NEEDED

- 7/16" Wrench
- Ratchet with 7/16" Socket
- Needle Nose Pliers
- Box Cutters / Utility Knife

MADE IN THE USA GUARANTEE



Our American made products are engineered, manufactured and assembled in Archbold, OH using USA made steel.



Expect more. get more.
FROM GRANITE INDUSTRIES

- Exceptional quality and service on every single product.
- Professional grade designs by our in house engineers.
- Industry leading warranties.
- Family owned and operated in the USA.

To view more products from
American Cart & Rack
scan the QR code with your phone
or visit AmericanCartAndRack.com



WARRANTY

3 Year Limited Warranty. Carts, excluding any finishes, casters and wheels are warranted for three (3) years from date of original purchase. Casters and wheels are warranted for 90 days from date of original purchase. We will repair, without charge, any defect due to faulty material or workmanship. These warranties do not cover failures due to abuse, misuse, improper installation, accidental damage or when repairs or modifications have been made or attempted to be made by anyone other than Granite Industries. Any defective products that meet warranty specifications and Granite Industries approval, may be returned to the factory to be repaired or replaced free of charge. (Granite Industries will pay to ship replacement item(s) to the customer; however the customer is responsible for shipment of products to the factory.) This remedy is the sole remedy in contract, tort or otherwise, and Granite Industries is not liable for incidental, consequential or special damages. These warranties give you specific legal rights, and you may have other rights which vary from state to state. Should you have any questions, contact Granite Industries (Proof of purchase may be required).



**GRANITE
INDUSTRIES**

Customer Service

877-447-2648

M-F, 8am - 5pm EST

SPECS

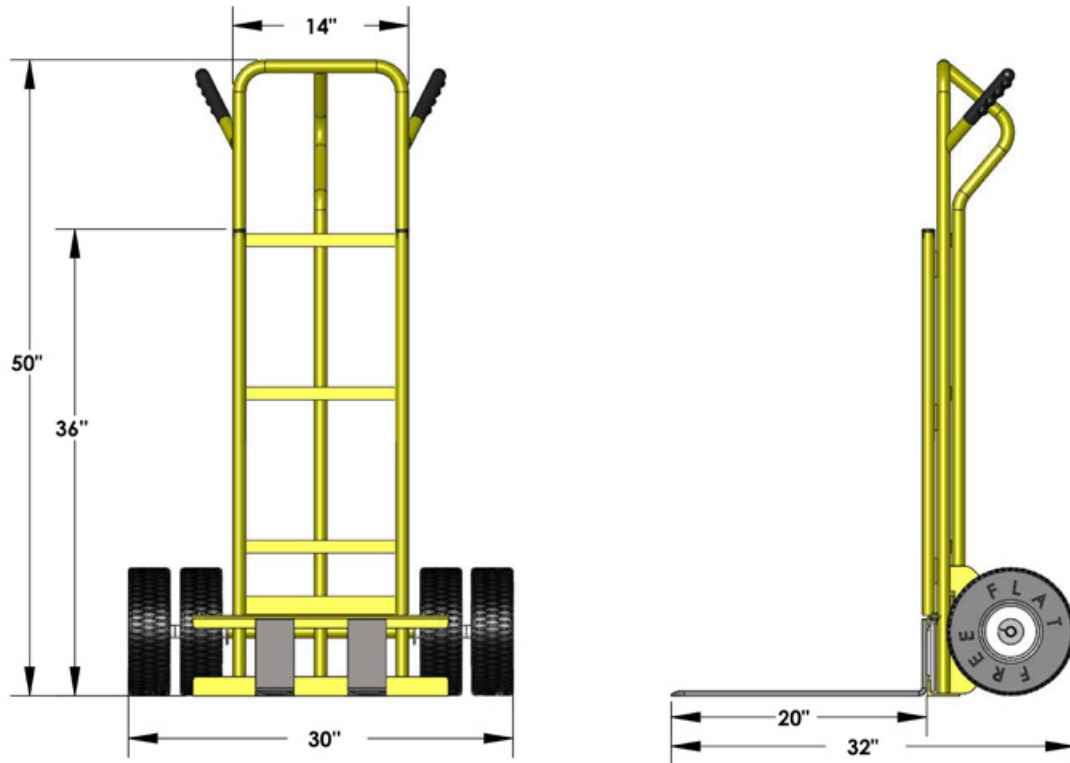

Overall Dimensions:	W: 30"	D: 32"	H: 50"
Forks:	W: 3"	D: 20"	
Weight:	74 lbs.	Capacity:	600 lbs.

PARTS DIAGRAM

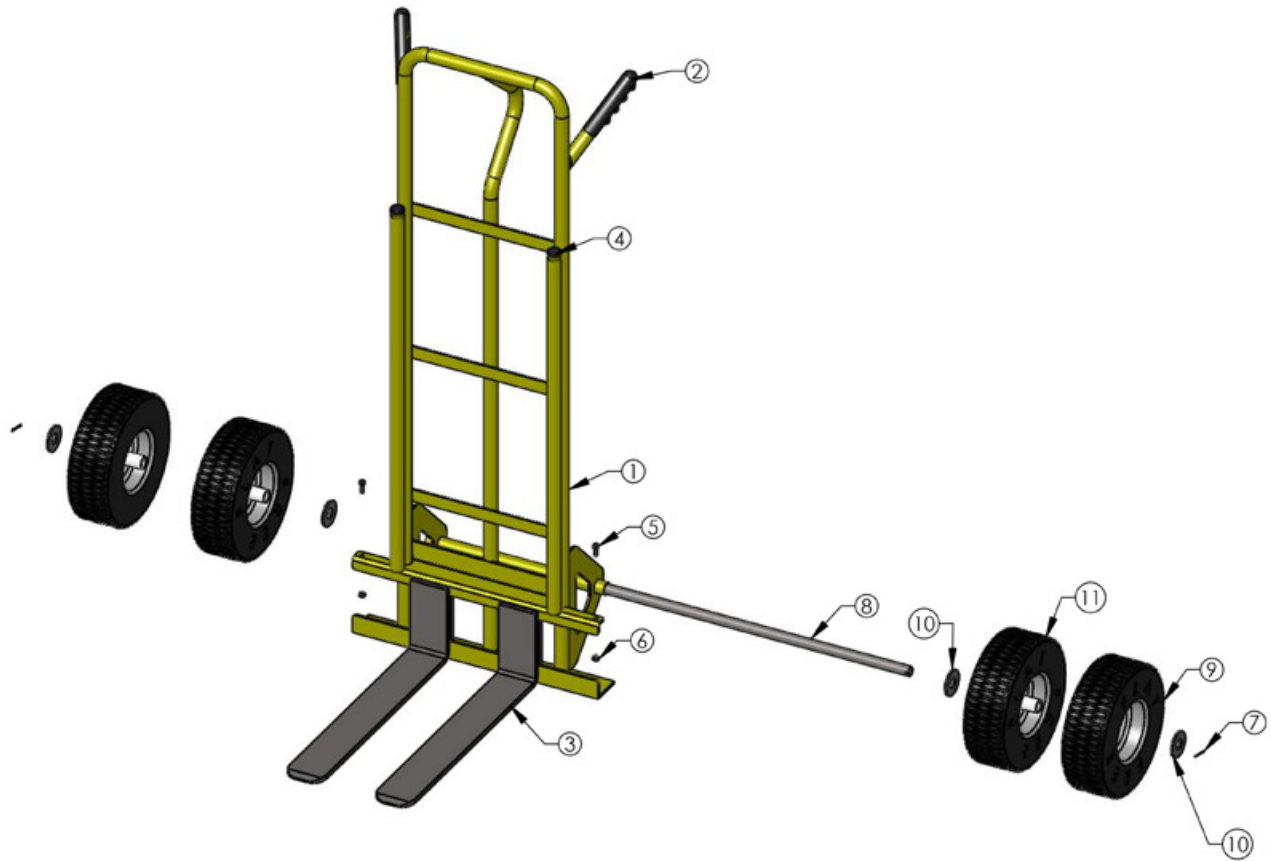

ITEM NO	QTY	PART NO	DESCRIPTION	
1	1	MI-12-5015	Fork Hand Truck Body	
2	2	PI-04-0109	Hand Grip	
3	2	MI-12-2060	Fork	
4	2	PI-04-0035	1" Round Cap	
5	2	PI-01-0011	1/4" Hex Bolt (3/4" L)	Use 7/16" Wrench/Socket
6	2	PI-01-0012	1/4" Lock Nut	Use 7/16" Wrench/Socket
7	2	PI-01-0226	1-1/4" Cotter Pin	
8	1	MI-04-0645	Axle Rod	
9	2	PI-06-0115	10" Offset Steel Hub Wheel	
10	4	PI-01-0451	3/4" Washer	
11	2	PI-06-0141	10" Steel Center Hub Wheel	

STEP 1: FRONT WHEEL ASSEMBLY

COMPONENTS		
ITEM NO	QTY	DESCRIPTION
1	1	Fork Hand Truck Body
7	2	1-1/4" Cotter Pin
8	1	Axle Rod
9	2	10" Steel Offset Hub Wheel
10	4	3/4" Washer
11	2	10" Steel Center Hub Wheel

TOOLS		
Needle Nose Pliers		

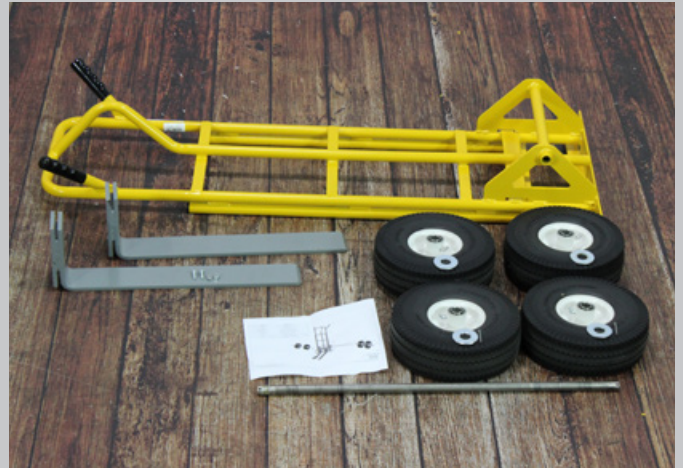

1

Insert the axle rod through the tube located on the back of the cart.



2

Slide a 3/4" washer followed by a 10" Steel center hub wheel onto the axle.



3

Slide a 10" offset wheel onto the axle, again making sure the offset side is facing towards the body of the cart.



4

Slide a washer onto the axle. Install the cotter pin and secure it by bending both ends outward with a **needle nose pliers**. Repeat steps 2-4 for the other side.

STEP 2: REAR AXLE ASSEMBLY

COMPONENTS		
ITEM NO	QTY	DESCRIPTION
3	2	Fork
5	2	1/4" Hex Bolt
6	2	1/4" Lock Nut

TOOLS	
7/16" Wrench	
7/16" Socket	



1

Slide the fork onto the cart frame as shown. Repeat for the other side.



2

Insert the 1/4" hex bolt into the hole and secure it with the 1/4" lock nut.



3

Tighten down using a **7/16" wrench and socket.** Repeat these steps for the other side.



Your Fork Hand Truck is now fully assembled.

NOTES:

[illegible]



GRANITE INDUSTRIES
595 EAST LUGBILL ROAD
877-447-2648
SUPPORT@GRANITEIND.COM