



# MULTI MOVER XT

WITH **FOLD DOWN REAR WHEELS**  
INSTRUCTION MANUAL



67245-75

## CONTENTS

Specs .....	3
Parts Diagram .....	4
Assembly .....	5

## TOOLS NEEDED

- Needle Nose Pliers
- Box Cutters / Utility Knife
- Wrenches: 1/2" & 3/4"
- Sockets: 1/2" & 3/4"

## MADE IN THE USA GUARANTEE



Our American made products are engineered, manufactured and assembled in Archbold, OH using USA made steel.



*Expect more. get more.*  
FROM GRANITE INDUSTRIES

- Exceptional quality and service on every single product.
- Professional grade designs by our in house engineers.
- Industry leading warranties.
- Family owned and operated in the USA.

To view more products from  
American Cart & Rack  
scan the QR code with your phone  
or visit [AmericanCartAndRack.com](http://AmericanCartAndRack.com)



## WARRANTY

3 Year Limited Warranty. Carts, excluding any finishes, casters and wheels are warranted for three (3) years from date of original purchase. Casters and wheels are warranted for 90 days from date of original purchase. We will repair, without charge, any defect due to faulty material or workmanship. These warranties do not cover failures due to abuse, misuse, improper installation, accidental damage or when repairs or modifications have been made or attempted to be made by anyone other than Granite Industries. Any defective products that meet warranty specifications and Granite Industries approval, may be returned to the factory to be repaired or replaced free of charge. (Granite Industries will pay to ship replacement item(s) to the customer; however the customer is responsible for shipment of products to the factory.) This remedy is the sole remedy in contract, tort or otherwise, and Granite Industries is not liable for incidental, consequential or special damages. These warranties give you specific legal rights, and you may have other rights which vary from state to state. Should you have any questions, contact Granite Industries (Proof of purchase may be required).



**GRANITE  
INDUSTRIES**

**Customer Service**

**877-447-2648**

**M-F, 8am - 5pm EST**

## SPECS

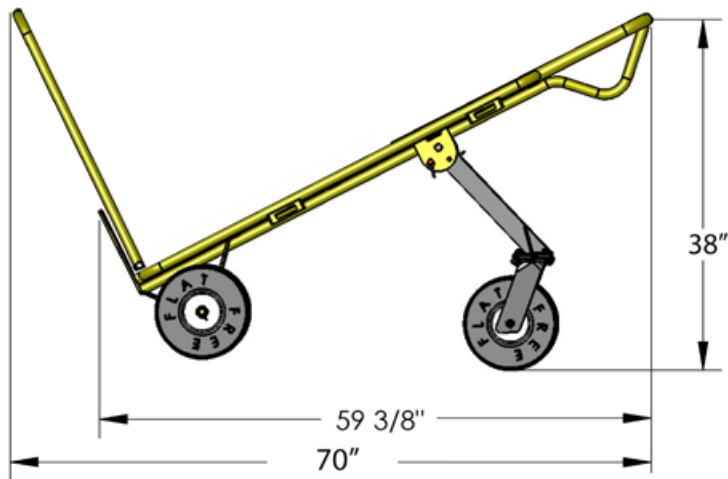
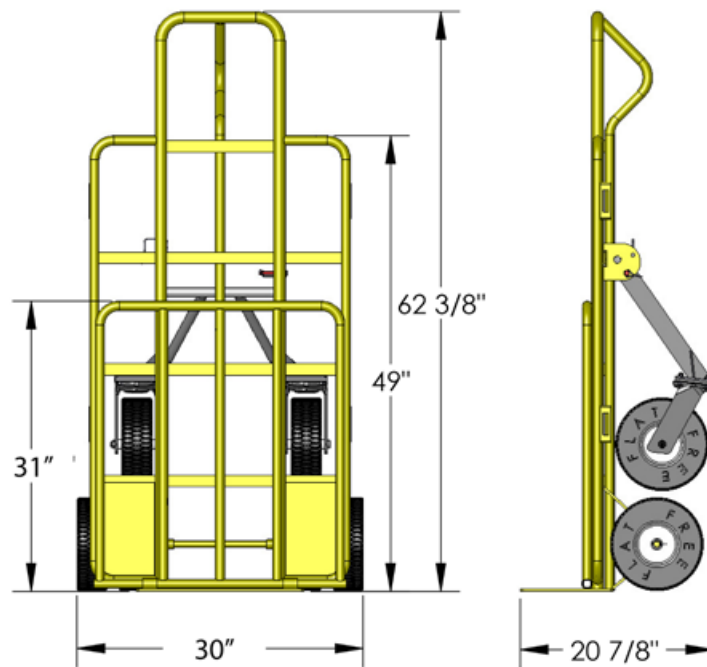

<b>Overall Dimensions:</b>	<b>W:</b> 30"	<b>D:</b> 70"	<b>H:</b> 38"
<b>Foot Plate:</b>	<b>W:</b> 27"	<b>D:</b> 31"	
<b>Weight:</b>	134 lbs.	<b>Capacity:</b>	1200 lbs.

\*Measurements taken on 4 wheels with folding foot plate open

## PARTS DIAGRAM

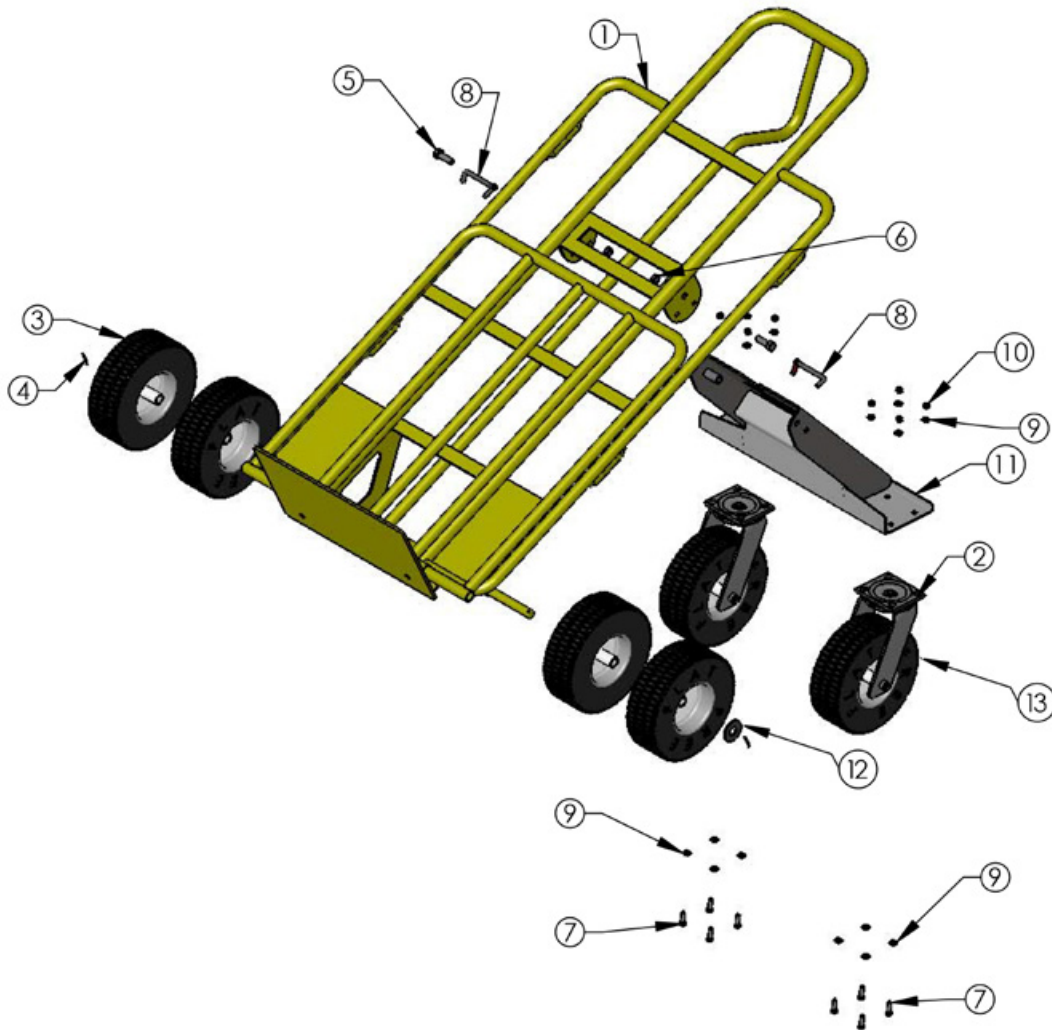

ITEM NO	QTY	PART NO	DESCRIPTION	
1	1	MI-12-5142	MULTI MOVER XT BODY	
2	2	PI-06-0055	CASTER MOUNT	
3	4	PI-06-0115	10" WHEEL W/ STEEL OFFSET HUB	
4	2	PI-01-0226	1-1/4" COTTER PIN	
5	2	PI-01-0043	1/2" HEX BOLT (1-1/4" L)	USE 3/4" WRENCH/SOCKET
6	2	PI-01-0121	1/2" NUT	USE 3/4" WRENCH/SOCKET
7	8	PI-01-0177	5/16" HEX BOLT (1" L)	USE 1/2" WRENCH/SOCKET
8	2	06013	3" HINGE PIN	
9	16	PI-01-0206	5/16" WASHER	
10	8	PI-01-0017	5/16" NUT	USE 1/2" WRENCH/SOCKET
11	1	MI-12-5143	REAR WHEEL ASSEMBLY	
12	2	PI-01-0451	3/4" WASHER	
13	2	PI-06-0051	10" WHEEL W/ STEEL CENTER HUB	
--	2	PI-01-0100	HEX BOLT 3/8" - 16 x 3"	
--	4	PI-01-0030	FLAT WASHER 3/8"	
--	2	PI-01-0037	LOCK WASHER 3/8"	
--	2	PI-01-0072	3/8" WING NUT	



## STEP 1: FRONT WHEEL ASSEMBLY

COMPONENTS		
ITEM NO	QTY	DESCRIPTION
1	1	Multi Mover XT Cart Body
3	4	10" Wheel w/ Steel Offset Hub
4	2	1-1/4" Cotter Pin
12	2	3/4" Washer

TOOLS	
Needle Nose Pliers	

Note: All steps are done with the cart facing down as shows in the photo to the right.



**1** Slide the first wheel onto the axle, making sure the flush side of the hub goes towards the body of the cart.



**2** Slide the second wheel onto the axle, this time making sure the offset side faces inward. The offset sides of both tires should be facing each other.



**3** Slide the washer onto the axle.



**4** Insert the cotter pin and secure it by bending both ends outward with a **needle nose pliers**. Repeat this process for the other side.



## STEP 2: REAR WHEEL ASSEMBLY

COMPONENTS		
ITEM NO	QTY	DESCRIPTION
5	2	1/2" Hex Bolt
6	2	1/2" Nut (1" L)
8	2	3" Hinge Pin
11	1	Rear Wheel Assembly
TOOLS		
3/4" Wrench		
3/4" Socket		



BOTTOM OF CART

**1** Place the rear wheel assembly over the frame toward the top of the cart. The flat side should be against the cart body, the flanges should face up. Insert the snap pins to help hold it in place.



**2** Insert the bolts through the cart body and rear axle assembly. Tighten down with a **3/4" wrench and ratchet.**



**3** For heavy duty use, we recommend using a bolt kit into the rear wheel assembly. Install a 3/8" washer onto the bolt, then insert the bolt into the rear wheel assembly. Add another 3/8" washer, then a lock washer.



**4** Secure the bolt in place with a wing nut. Repeat the process for the other side.



## STEP 3: INSTALL CASTER MOUNTS

COMPONENTS		
ITEM NO	QTY	DESCRIPTION
2	2	Caster Mount
7	8	5/16" Hex Bolt (1"L)
9	16	5/16" Washer
10	8	5/16" Nut

TOOLS		
1/2" Wrench		
1/2" Socket		



**1** Align the caster mount onto the holes. Place a 5/16" washer onto the 5/16" bolt and insert the bolt through the rear wheel assembly and caster mount.



**2** Slide another 5/16" washer onto the bolt, followed by the lock nut. Tighten each nut (but not all the way) with a **1/2" wrench** and a **1/2" socket**.



**3** Make any adjustments to the caster mount to ensure it is on straight. Then finish tightening down all of the nuts.



Once installed your caster mounts should look like this.



## STEP 4: INSTALL REAR WHEELS

### COMPONENTS

ITEM NO	QTY	DESCRIPTION
3	2	10" Wheels with steel center hub

### TOOLS

3/4" Wrench

3/4" Socket



# 1

Remove the bolt and bushing from the caster mount using a **3/4" wrench and socket**.



# 2

Insert the bushing through one of the wheel hubs, then position the caster wheel into the caster mount.



# 3

Insert the 1/2" bolt and fasten the 1/2" nut into place using a **3/4" wrench and 3/4" socket**.



Your Multi Mover XT with Rear Wheels is now fully assembled.